

Drive Model	Motor Model	Power (kw)	Speed (rpm)
VD1-040SE1G	WD60M-04030S-E1B	0.4	3000
VD1-040SE1G	WD80M-04030S-E1B	0.4	3000
VD1-075SE1G	WD80M-07530S-E1B	0.75	3000
VD1-040SE1G5	WD60M-04030S-E1F	0.4	3000
VD1-075SE1G-20S	WD80M-07520S-E1B	0.75	2000



## SPECIFICATION

Item	Content	
Control Method	IGBT PWM controlled sine wave current drive	
Encoder	2500ppr incremental encoder	
Input Signal	8*DI, Select input function according to function code configuration	
Output Signal	4*DO, Select input function according to function code configuration	
Analog Signal Input	2 channel AI input, range(-10v~10v)	
Pulse Signal Input	Open collector or differential input	
Pulse Feedback Output	A,B,Z differential output	
Communication	Modbus channel 1	
	PC RS422 port, Parameter setting, monitoring status, waveform viewing, parameter auto-tuning, via computer	
Braking Resistor	Built-in braking resistor, supporting external braking resistor	
Automatic Parameter Tuning	It can cooperate with the host computer for automatic load inertia identification and automatic rigidity level, and the parameters self-tuning.	
Waveform Viewing	View position, speed, torque and other curves on PC in real time	
General Function	Vibration Suppression	Suppress mechanical vibration by setting vibration suppression parameters
	Protective Function	Overvoltage, undervoltage, overcurrent, overspeed, overload, overheating, encoder failure, excessive position deviation, torque limit, speed limit, etc.
	Universal Control DI	Servo enable (SON), fault and warning clear (A-CLR), forward drive prohibition (POT), reverse drive prohibition (NOT), command reverse (C-SIGN), emergency stop (E-STOP), Gain switching (GAIN-SEL)
	Universal Control DO	Servo ready (RDY), fault signal (ALM), warning signal (WARN), rotation detection (TGON), zero speed signal (ZSP), torque limit (T-LIMIT), speed limit (V-LIMIT), servo on state output (SRV-ST)
	Input Control	(C-SIGN) Deviation counter clear (CL), electronic gear switching 1 (GEAR-SEL), pulse input inhibit (INH), command inversion (C-SIGN)
Output Control	Positioning complete (P-COIN), positioning approach (P-NEAR)	
Position Mode	Pulse Frequency	max. 500khz
	Pulse Input	Pulse Type Pulse + Direction, CCW/CW pulse, Orthogonal coding
	Electronic Gear Ratio	Range: 0.01 ~ 100
	Pulse Filtering	low-pass filter or smooth filter
	Pulse Output	Differential orthogonal coding A, B, Z output, PPR is settable
Torque Limit	Forward / reverse operation torque limit is settable	
Speed Limit	Forward / reverse operation speed limit is settable	

	Control Input	Zero clamp (ZCLAMP) ,command inversion (C-SIGN) ,Speed limit analog input
	Control Output	Speed consistent (V-COIN) ,Speed approach (V-NEAR)
Speed Mode	Command	Analog Input -10V~+10V analog input
	Input	Internal
		Command
	Soft Start	acc. and dec. time are settable
	Zero Clamp	Motor speed can be clamped to zero via the setting of zero clamp function
	Torque Limit	set the torque limit
	Command Output	Command inversion (C-SIGN) , Speed limit analog input
Torque Mode	Control Output	Torque reached (T-COIN) , speed limit (V-LIMIT)
	Command Input	Analog Input -10V~+10V analog input
	Input	Internal
		Command
	Speed Limit	The maximum speed in torque mode

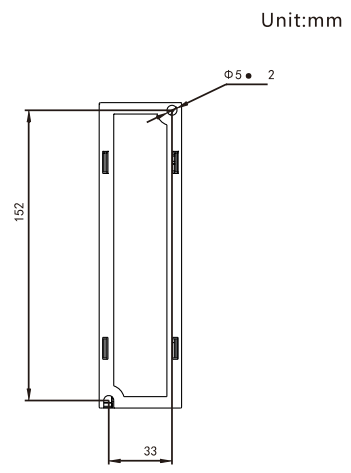
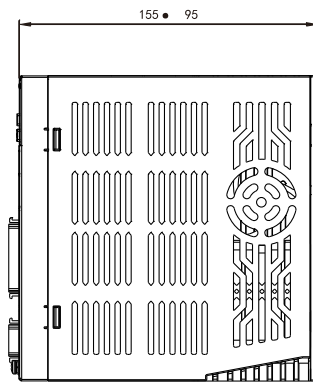
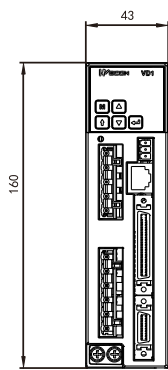

Unit:mm

## 60 Series Motor Specification

Moto model	WD60M-04030S-E1B
Rated power (kW)	0.4
Rated current (A)	2.6
Rated torque (N·m)	1.27
Max. torque (N·m)	3.81
Rated speed (r/min)	3000
Rotor Inertia (Kg·m <sup>2</sup> )	0.407×10 <sup>-4</sup>
Torque constant-KT (N·m/A)	0.48
Voltage constant-KE (V/1000r/min)	31
Armature resistance (Ω)	3.8
Armature inductance (mh)	19.2
Electric constant (Ms)	5.05
Drive input voltage (V)	AC220
Encoder (P/R)	Incremental encoder 2500ppr
Number of pole pairs	4
Insulation class	F
Environment	Ambient temperature: -20 °C ~ + 40 °C Ambient humidity: relative humidity ≤90%
Ip rating	IP65

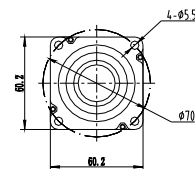
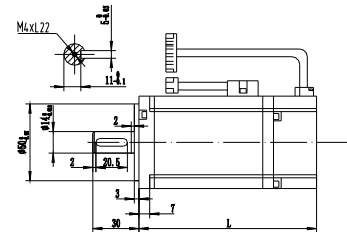

Moto model	WD60M-04030S-E1F
Rated power (kW)	0.4
Rated current (A)	2.1
Rated torque (N·m)	1.27
Max. torque (N·m)	4.46
Rated speed (r/min)	3000
Rotor Inertia (Kg·m <sup>2</sup> )	0.61×10 <sup>-4</sup>
Torque constant-KT (N·m/A)	0.6
Voltage constant-KE (V/1000r/min)	32.3
Armature resistance (Ω)	7.1
Armature inductance (mh)	13.8
Electric constant (Ms)	1.94
Drive input voltage (V)	AC220
Encoder (P/R)	Incremental encoder 2500ppr
Number of pole pairs	5
Insulation class	F
Environment	Ambient temperature: -20 °C ~ + 40 °C Ambient humidity: relative humidity ≤90%
Ip rating	IP65

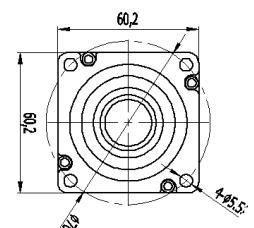
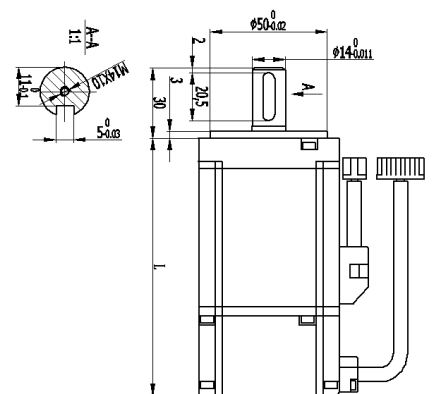

## 80 Series Motor Specification

Moto model	WD80M-04030S-E1B	WD80M-07530S-E1B	WD80M-07520S-E1B
Rated power (kW)	0.4	0.75	0.75
Rated current (A)	2	3	3
Rated torque (N·m)	1.27	2.39	3.5
Max. torque (N·m)	3.8	7.1	10.5
Rated speed (r/min)	3000	3000	2000
Rotor Inertia (Kg·m <sup>2</sup> )	1.05×10 <sup>-4</sup>	1.82×10 <sup>-4</sup>	2.63×10 <sup>-4</sup>
Torque constant-KT (N·m/A)	0.64	0.8	1.17
Voltage constant-KE (V/1000r/min)	40	50	71
Armature resistance (Ω)	4.6	3	3.7
Armature inductance (mh)	8.1	5.9	9.1
Electric constant (Ms)	1.76	1.96	2.45
Drive input voltage (V)	AC220		
Encoder (P/R)	Incremental encoder 2500ppr		
Number of pole pairs	4		
Insulation class	F		
Environment	Ambient temperature: -20 °C ~ + 40 °C Ambient humidity: relative humidity ≤90%		
Ip rating	IP65		

